

# E-Consultations Instructions to Access





Thank you for joining us in the  
**two-week e-consultations**  
(now ongoing through 8 March) as part of the  
preparations for the drafting of a framework for a  
**People's Pact for the Future.**





# How to access

1. Go to [groups.google.com](https://groups.google.com) - Here you will see the groups you've signed for.

\*Note: To be able to see the groups you need to confirm a couple steps first:

- a. Are you logged in with the same gmail account that you have registered for the group?
- b. If you are using a corporate account you may need to associate you email account to Google:

1. Go to [google.com](https://google.com) - Select **Create an account** **at the top right corner**, or by visiting [here](#).

*\*Make sure you are logged out of all other Google/Gmail accounts first.*

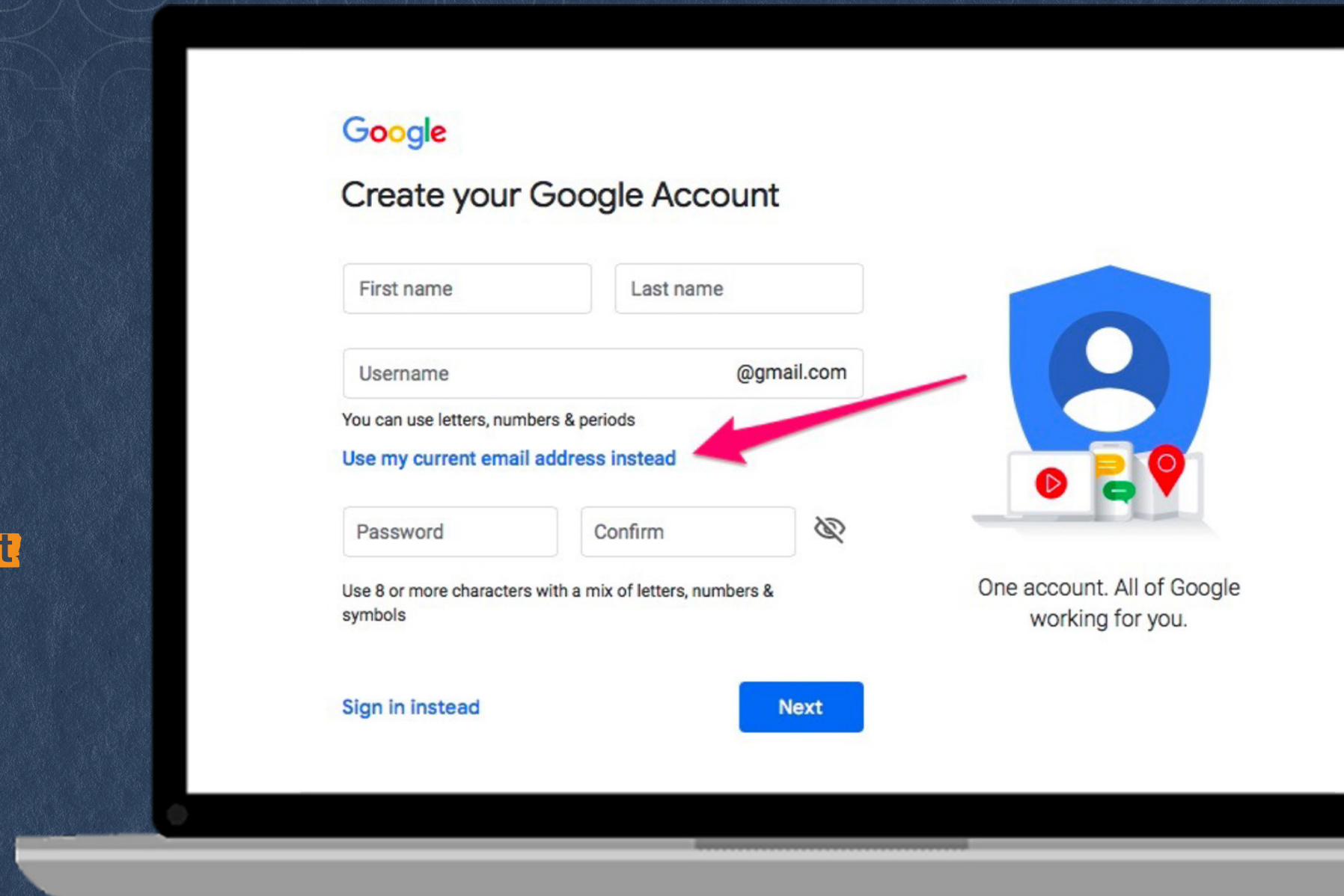



# How to access

2. Fill out the Create your Google Account form. Then select **"Use my current email address instead"**. Use a new password for the Google-linked account.
3. Once complete, let your Account Manager know the email address you registered with Google.

Google

## Create your Google Account

First name Last name

Username @gmail.com

You can use letters, numbers & periods

[Use my current email address instead](#)

Password Confirm

Use 8 or more characters with a mix of letters, numbers & symbols

[Sign in instead](#) [Next](#)

One account. All of Google working for you.



# How to access

2. Each track will start on its scheduled date. The co-facilitators will send you a welcoming message to get the conversations started.

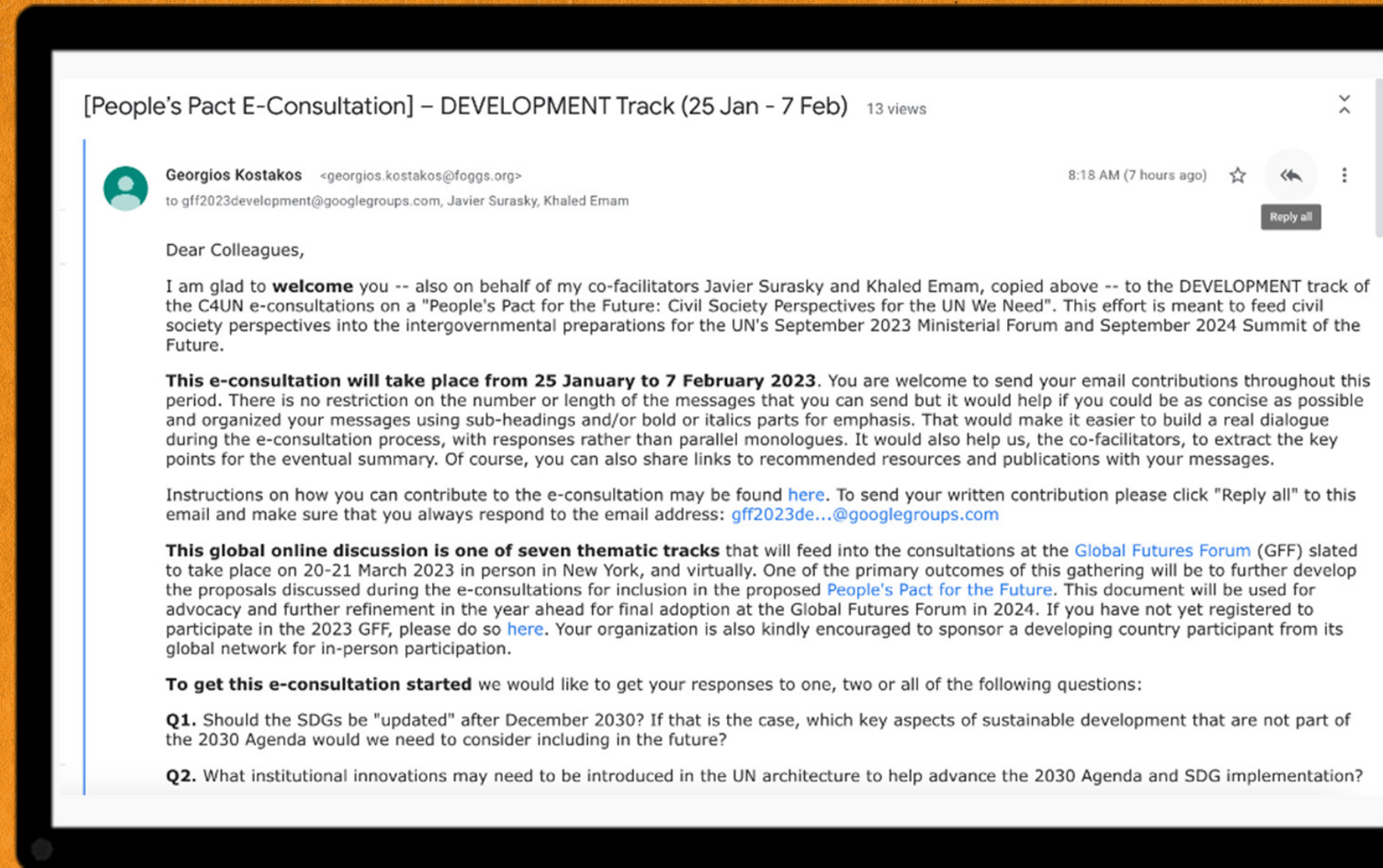



# How to access

3. You can either respond to the message by clicking on **“Replying to all”** in the right corner of the screen or you can start a **“New conversation”** by clicking the bottom in the left side of the menu bar.

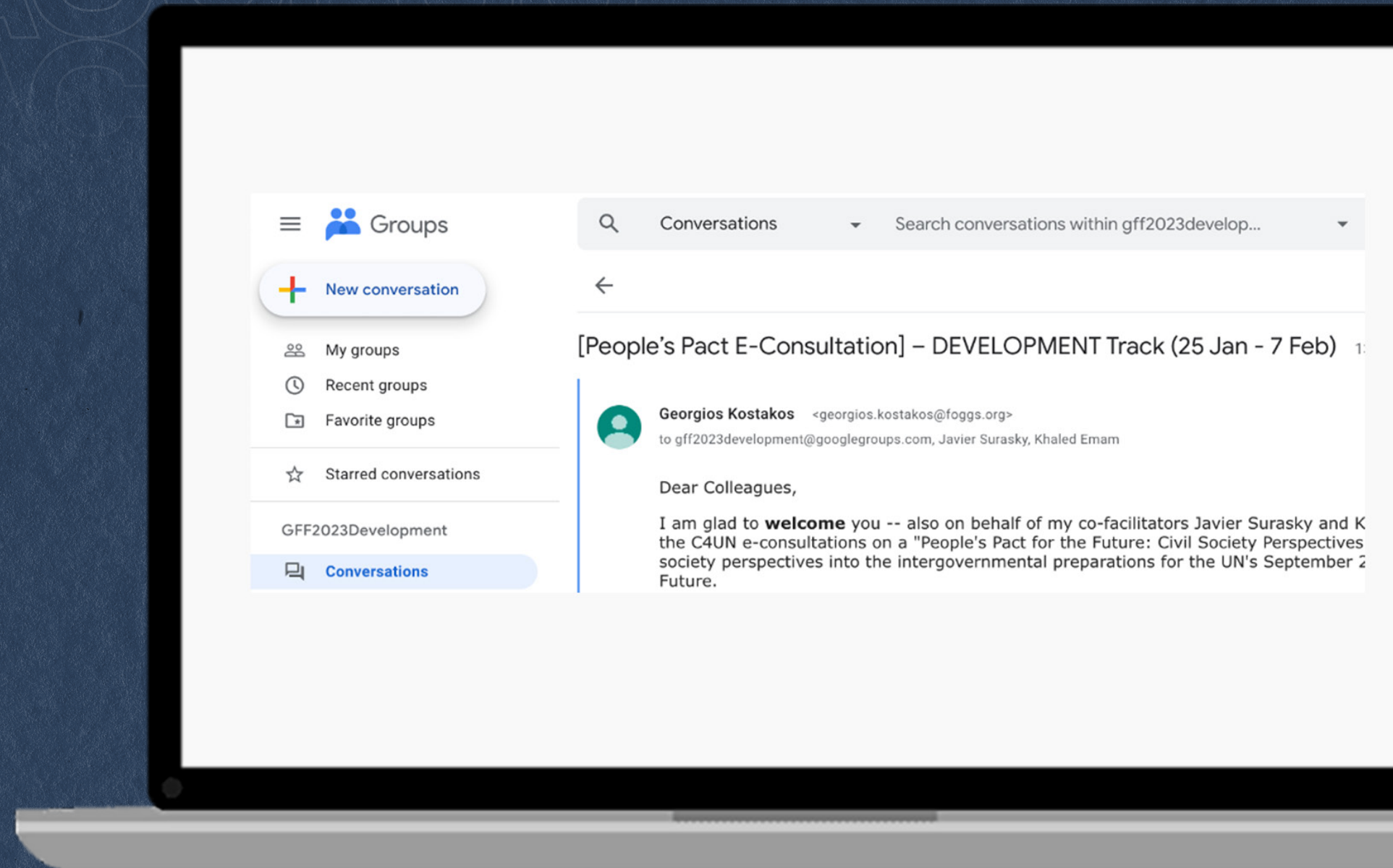





\*If you need any further assistance, please send an email to [gfutureforum@gmail.com](mailto:gfutureforum@gmail.com)

Happy e-consulting!

